

Line Strong 3D Heavy duty switches

Protection up to 250 meters



The Line Strong 3D is a Heavy Duty Safety Rope Pull switch designed to protect long conveyor lengths. The die-cast housings are robust to survive indoor or outdoor use including washdown (IP67 rating).

Lengths over 2 Km can be achieved with less than 20 switches. A bi-color LED ensures switch status can be seen easily from a distance. They have 4NC 2NO contacts to ensure flexibility with all modern control applications.

Shorter rope spans up to 200m can be achieved by using just one switch, therefore making a cost effective solution and also reducing electrical wiring runs.

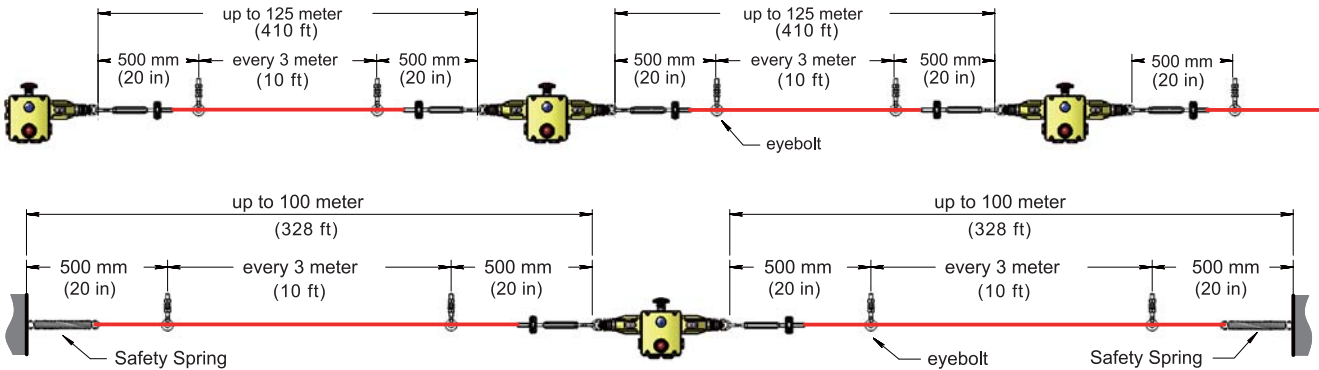

It is recommended when using a Safety Spring that a maximum of one corner pulley is used.

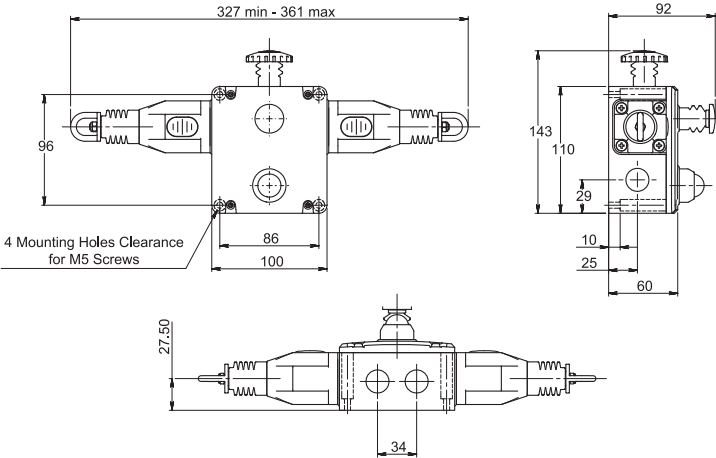

Standards:	IEC 947-5-1	IEC947-5-5	EN954-1	EN62061
	UL508	ISO13850	ISO13849-1	
Safety Classification and Reliability Data:				
Mechanical Reliability B10d	1.5 x 10 ⁶ operations at 100mA load			
EN 954-1	up to Category 4 with Safety Relay			
ISO 13849-1	up to PLe depending upon system architecture			
EN 62061	up to SIL3 depending upon system architecture			
Safety Data - Annual Usage	8 cycles per hour / 24 hours per day / 365 days			
PFHd	<1.0 x 10 ⁻⁷			
Proof Test Interval (Life)	21 years			
MTTFd	214 years			
Enclosure / Cover	Die-Cast – Painted Yellow			
External Parts	Stainless Steel			
IP Rating	IP67 (NEMA 6)			
Rope Spans	Dual Head 250m.			
Rope Tension device	Tensioner / Gripper - Quick fixing			
Rope Type:	4.0 mm Outside Dia. Steel inner – PVC sheath			
Mounting	4 x M5			
Mounting position	Any			
Conduit entries	4 x M20 or 4 x 1/2" NPT by part number			
Torque settings	Mounting M5 4.0 Nm Lid T20 Torx M4 1.5 Nm Terminals 1.0 Nm			
Ambient Temperature	-25C +80 C.			
Vibration resistance	10-500Hz 0.35mm			
Shock resistance	15g 11ms			
Tension Force (typical mid setting)	130N.			
Typical Operating Force (Rope pulled)	< 125N. < 300mm Deflection			
Mechanical Life	1,000,000 operations			
Weight	1320 g.			
Contact type	IEC 947-5-1 Double break Type Zb Snap Action up to 4NC (positive break) 2NO (Auxiliary)			
Contact Material	Silver			
Termination	Clamp up to 2.5 sq. mm conductors			
Rating	Utilisation Category : AC15 A300			
Operational Rating	240V. 3A.			
Thermal Current (Ith)	10A.			
Rated Insulation Voltage (Ui)	500V.			
Withstand Voltage (Uimp)	2500V.			
Short Circuit Overload Protection	Fuse Externally 10A. (FF)			

Line Strong 3D

- 2TLA050204R0332 LineStrong3D, 4NC/4NO, M20 ESTOP/LED 24VDC
- 2TLA050204R1332 LineStrong3D, 4NC/4NO, NPT ESTOP/LED 24VDC
- 2TLA050204R0333 LineStrong3D, 4NC/4NO, M20 ESTOP/LED 110VAC
- 2TLA050204R1333 LineStrong3D, 4NC/4NO, NPT ESTOP/LED 110VAC
- 2TLA050204R0334 LineStrong3D, 4NC/4NO, M20 ESTOP/LED 230VAC
- 2TLA050204R1334 LineStrong3D, 4NC/4NO, NPT ESTOP/LED 230VAC
- 2TLA050204R0232 LineStrong3D, 4NC/4NO, M20 LED 24VDC
- 2TLA050204R1232 LineStrong3D, 4NC/4NO, NPT LED 24VDC
- 2TLA050204R0233 LineStrong3D, 4NC/4NO, M20 LED 110VAC
- 2TLA050204R1233 LineStrong3D, 4NC/4NO, NPT LED 110VAC
- 2TLA050204R0234 LineStrong3D, 4NC/4NO, M20 LED 230VAC
- 2TLA050204R1234 LineStrong3D, 4NC/4NO, NPT LED 230VAC
- 2TLA050204R0130 LineStrong3D, 4NC/4NO, M20, ESTOP
- 2TLA050204R1130 LineStrong3D, 4NC/4NO, NPT ESTOP
- 2TLA050204R0030 LineStrong3D, 4NC/4NO, M20
- 2TLA050204R1030 LineStrong3D, 4NC/4NO, NPT

For all ABB Jokab Safety Rope Switches, the normally closed (NC) circuits are closed when the system is tensioned correctly and the switch has been reset.